



# AIR QUALITY, TREES AND DESIGN

Johanna Gibbons  
Rob MacKenzie

TREES, PEOPLE AND  
THE BUILT ENVIRONMENT 3  
International Urban Trees  
Research Conference  
6<sup>th</sup> April 2017

# ANGEL BUILDING

J & L Gibbons 2007-2010



‘Here, there has been no fear of greenery, and the planting and the shimmering trees form a foil to the crisp lines of the new facades and help to aerate this busy part of Islington’.

Tony Chapman, Architecture 11, RIBA Building of the Year



## awards

2011 RIBA Award  
2011 RIBA Stirling Prize shortlisted  
2011 NLA Award, Working category  
2011 BCO Judges Special Award  
2011 BCO National Award  
2011 Civic Trust commendation  
2015 RE:LEAF Award Trees and Development



Angel

St John Street A1

Pavement park

Existing tree group

New plane tree group

Negotiated building line

Original building line

Existing tree group

Pentonville Road

New plane tree group

Existing tree group

Existing tree group

Biodiversity corridor

Green infrastructure on the highway





Leafing out in spring



Summer in full leaf



Before



Visualisation for planning submission

**Procuring our visualisations**



bird bakery  
S. USUAL



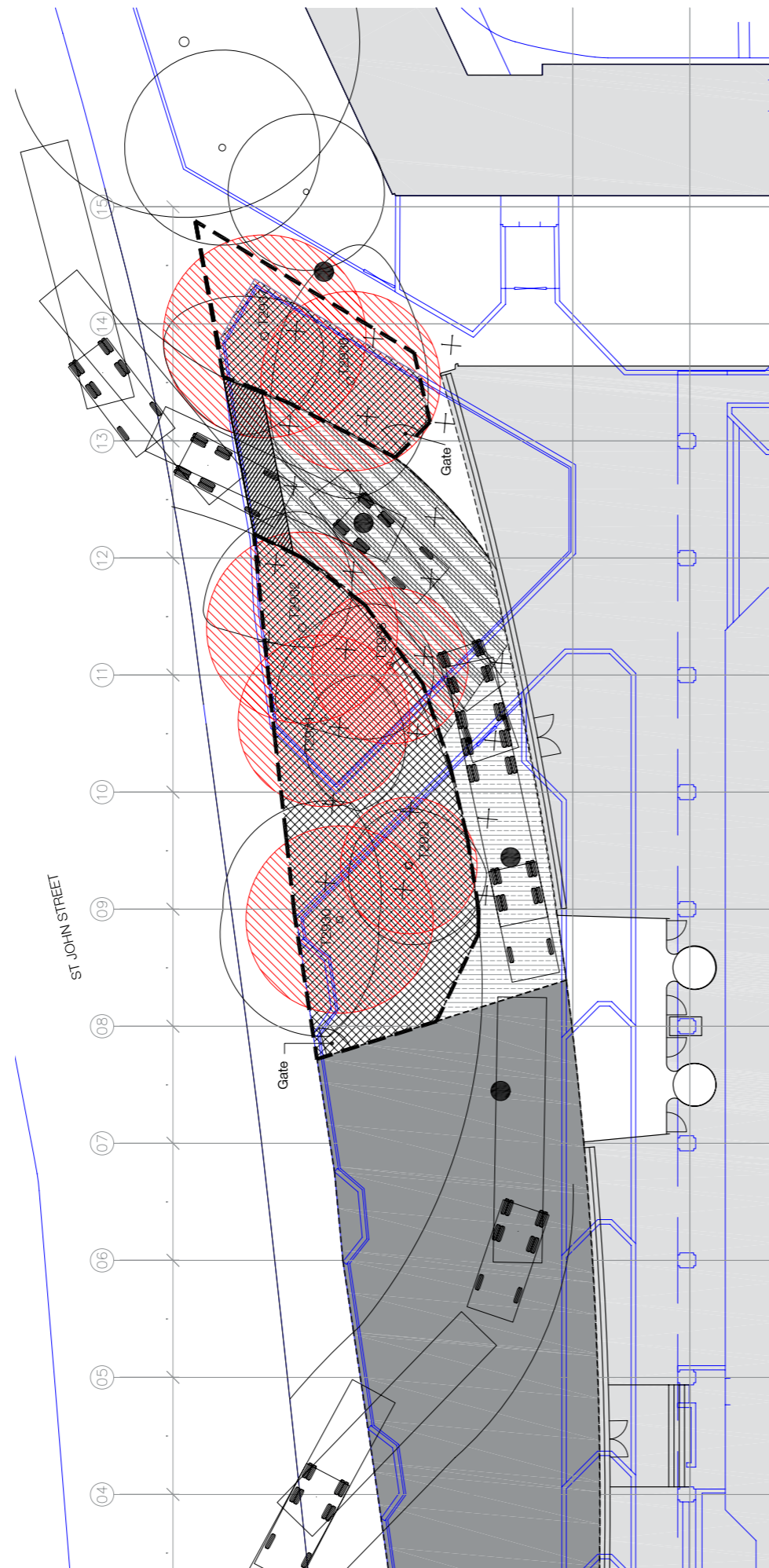

**The benefits of large species trees in urban landscapes: a costing, design and management guide**



The Angel Building has been acknowledged as an exemplar case study by CIRIA.

‘This development has proved to be beneficial to both the developer and the local authority, and should be seen as an exemplar approach to development in constrained urban environments, particularly with regard retaining and supplementing mature trees in the city.’

**The reality of construction**



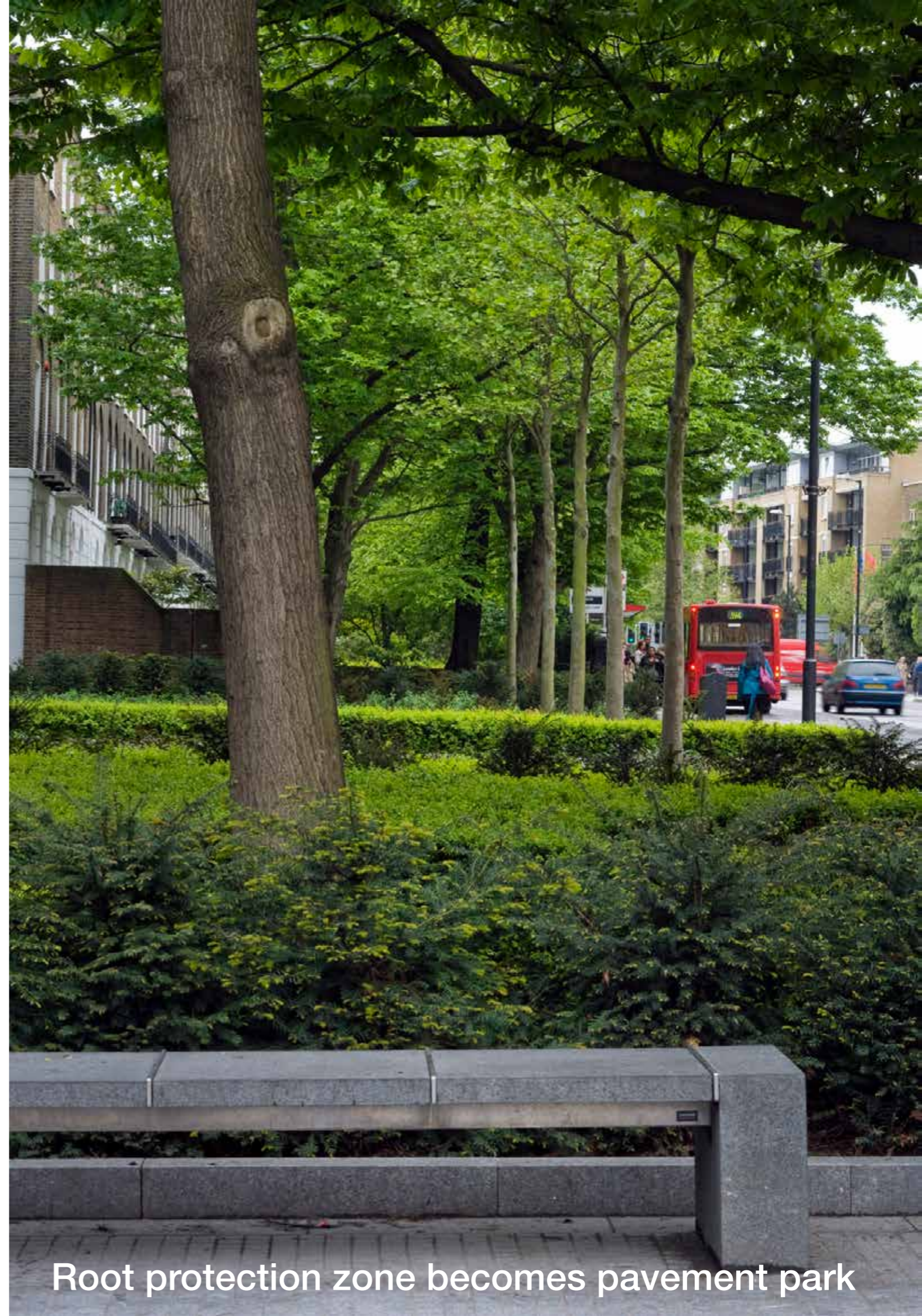

Root protection zone becomes pavement park



**B** Stone edge section

**A** Typical paving layout



## Interlocking grey and green infrastructure



Semi mature planes advanced procured and located to enable a full canopy to develop in time



High end tenants attracted



A landscape that contributes to the wider green infrastructure of the A1 road corridor



Autumn tree canopy with hedges that define historic property lines



DALSTON EASTERN CURVE GARDEN  
J & L Gibbons with muf architecture/art  
2007-2017



Dalston Eastern Curve imagining an urban forest



Under construction



Under construction



Before



After

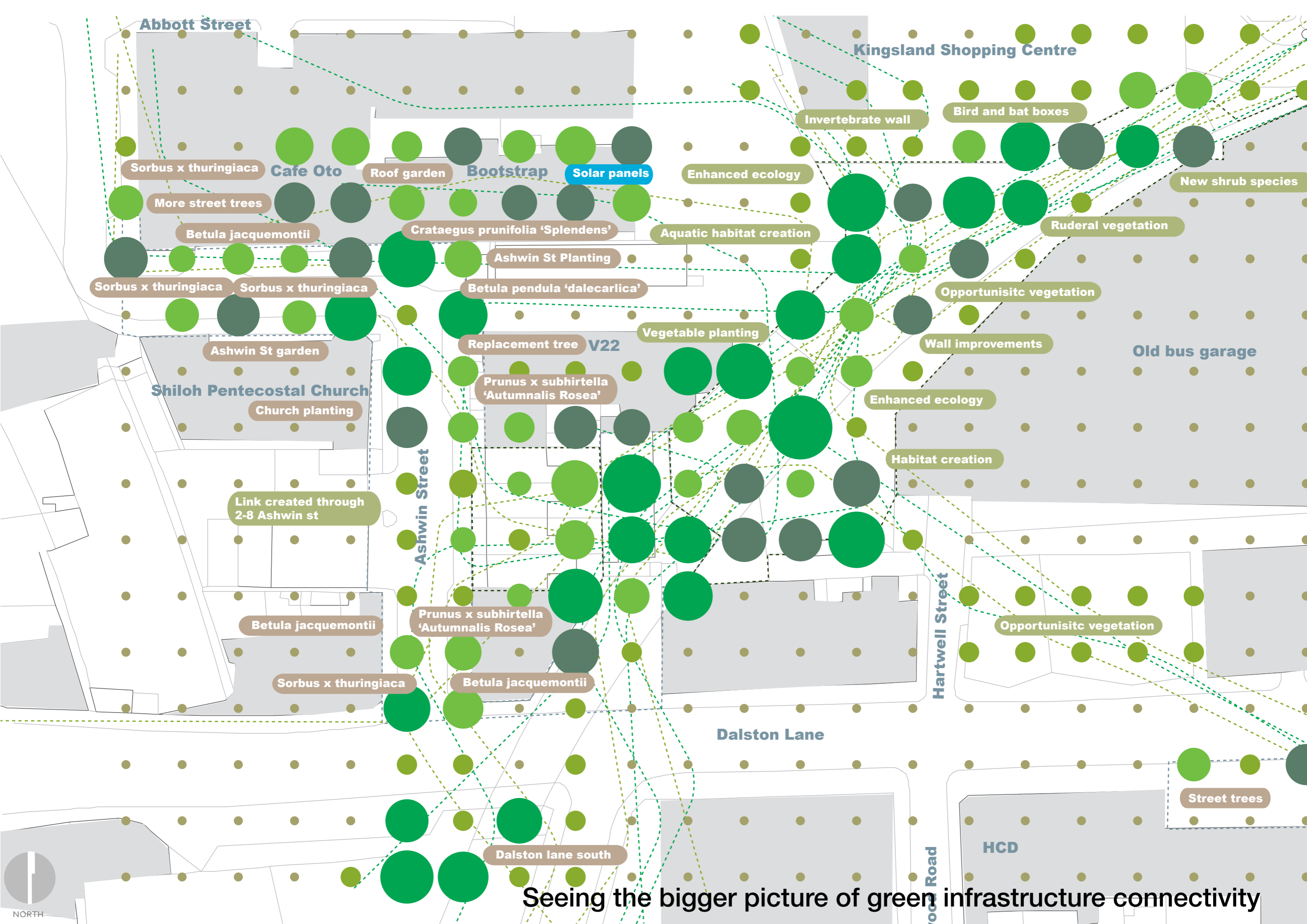

# EASTERN CURVE ECO PARK



TO THE EASTERN CURVE ECOPARK



TO THE EASTERN CURVE ECOPARK



A protected environment



Urban forestry that protects and nurtures visitors from Dalston Lane





Natural capital - a sensory experience